

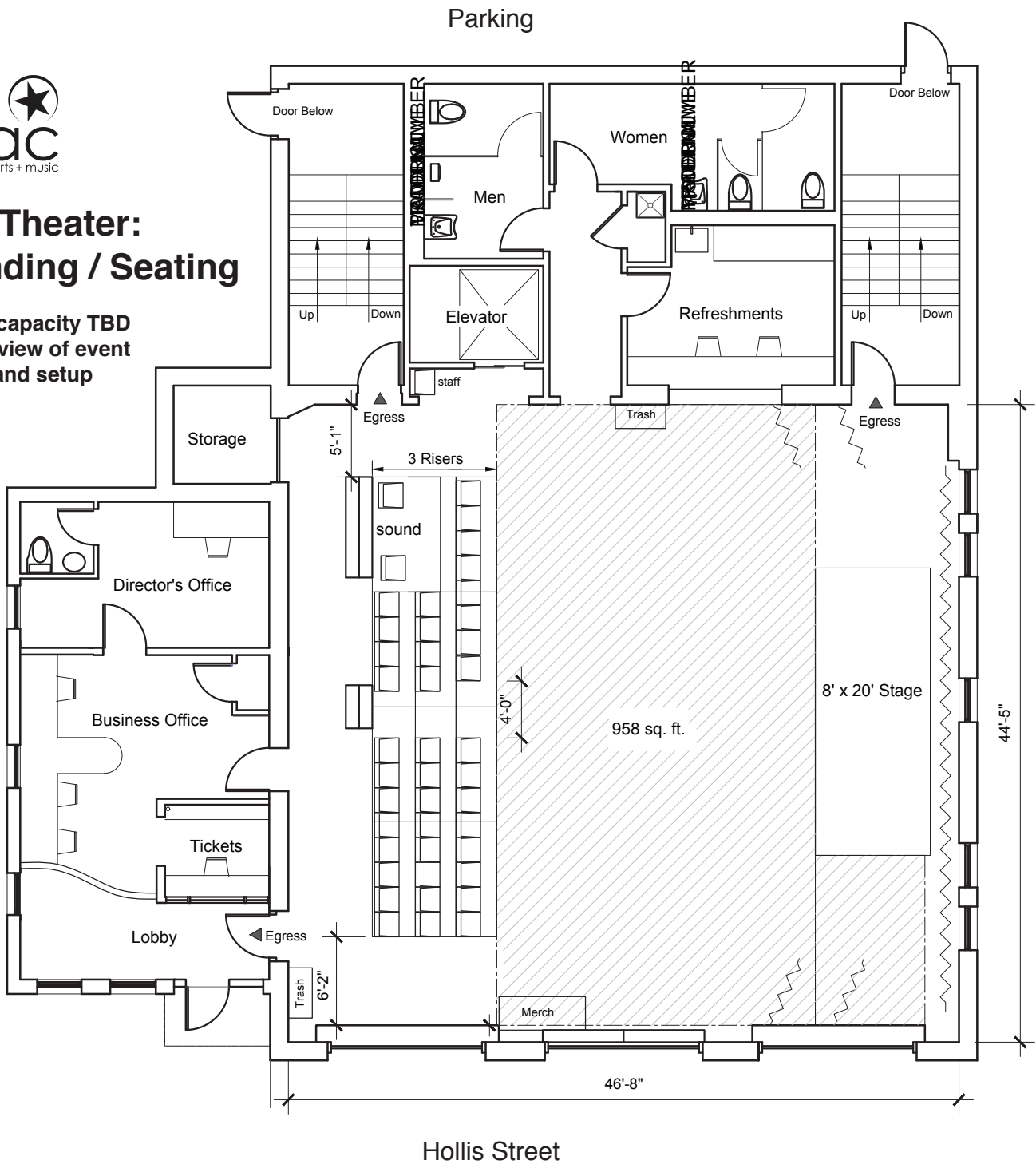

The Theater: Standing / Seating

Actual capacity TBD
after review of event
scope and setup

Parking Entrance



Parking Exit

Tech & Backline:

- + Raised 8x20 stage
- + Yamaha GP1 Baby Grand Piano 5'3"
- + Yamaha P90 Electric Keyboard
- + Fender Rumble 100 Bass Amp
- + Mapex Drum kit (we suggest bringing your own cymbals and snare)
- + Behringer X32 Compact Digital Mixer with Built-In Effects, Compressor, And EQ for each channel
- + Smartfader 4096 DMX lighting controller

Location and Contacts:

160 Hollis Street
Framingham, MA, 01702
408-405-2787
<http://www.atac160.org>
@atac160

Rentals: rentals@atac160.org
Production: production@atac160.org